

滑桿式虎鉗
CENTRAL SLIDING BAR VISE

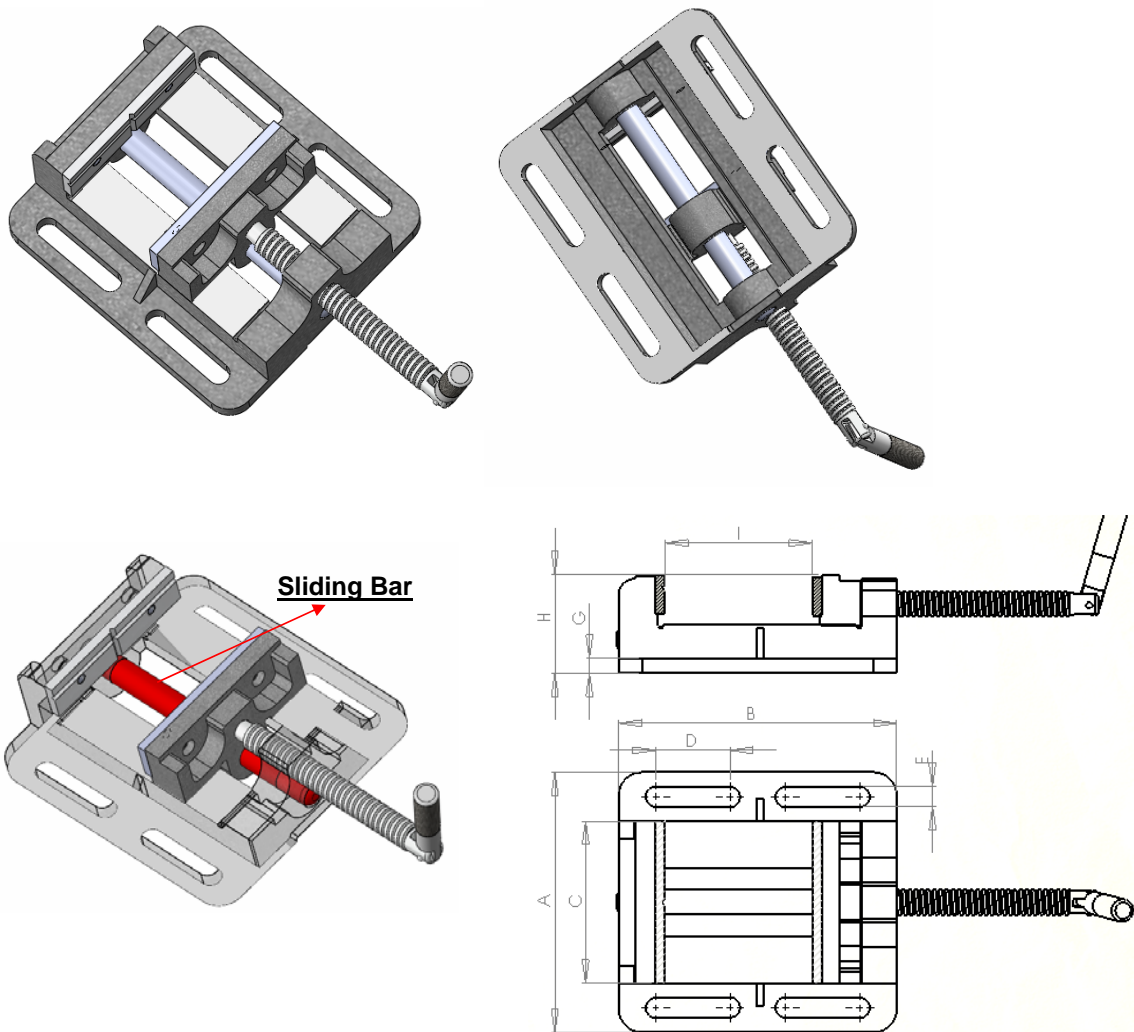

Feature:

- Suitable for clamping work piece on drill press machine
- Slide bar design makes work piece is firmly fixed by jaw pair without any inclined situation of the jaws
- Designed with solid structure, main body is made of FC15, assemble a pair of jaws
- Front fixed prismatic jaw with cross V-grooves is designed for clamping work piece firmly in both vertical & horizontal

Unit: mm

Order No.	A	B	C	D	E	G	H	I	weight
106A-3	142	159	82	47.5	13	10	57	75	2.8
106A-4	167	180	104	48	13	10	62.5	91	3.6
106A-5	191	208	128	66	13	11	68	110	5.2
106A-6	228	250	153	74.5	14	12	79.5	140	7.5