

千斤頂
SCREW JACK

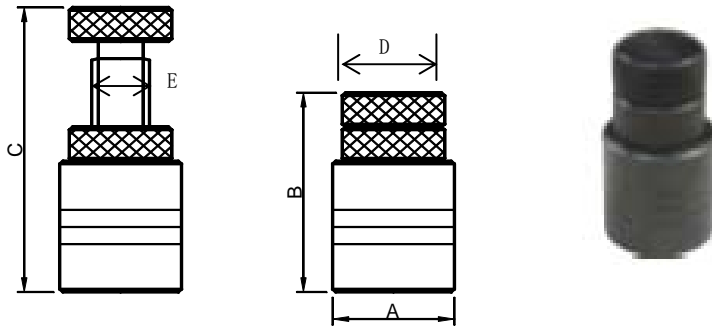

Type I

- ※ Material: S45C
- ※ Surface treatment: black oxide furnished
- ※ Height is adjustable

Max. support loading	
S-100	15.0 tons
S-150	21.5 tons
S-250	46.0 tons

Unit: mm

Order no.	E	Applicable range (B-C)	A	D
S-70	Tr14x3	56~75	32	25
S-100	Tr18x4	76~105	40	32
S-150	Tr24x5	102~160	50	40
S-250S	Tr32x5	142~235	55	45
S-250L	Tr32x5	160~260	65	50
S-300	Tr32x5	200~345	65	50
S-400	Tr32x5	300~430	70	55

Type I

- ※ Material: S15C
- ※ Surface treatment: black oxide finished
- ※ Height is adjustable

Part no.	E	Applicable range (B-C)	A	D
TS-100	TW(19-6teeth/in)	70~100	38	28
TS-150	TW(24-6teeth/in)	95~150	50	38
TS-250	TW(30-6teeth/in)	140~235	55	45
TS-400	TW(30-6teeth/in)	230~425	55	45